



DIEPPE AQUATIC CENTRE

DIEPPE, NEW BRUNSWICK

(Reprinted with permission from ArcelorMittal Dofasco Steel Design, 2009)

DESIGN AND CONSTRUCTION TEAM

ARCHITECT: Dan S. Hanganu, Architects/ Architecture 2000 Inc. en Consortium Architecture 2000 Inc.: Dan S. Hanganu, Architecte

GENERAL CONTRACTOR: Ellis Don

SITE SUPERVISION: Celtic Consulting Management Inc.

INSULATED WALL PANELS: Vicwest – Atlantic Canada

CIVIL ENGINEERS: Terrain Group Inc.

CONSULTING MECHANICAL ENGINEERS: Hoadley Engineering Inc.

STRUCTURAL CONSULTANTS: Valron Engineers Inc.

ELECTRICAL CONSULTANTS: MCW Maricor

POOL CONSULTANTS: NACEV Consultants Inc.

PHOTOGRAPHY: Ron Ward/Times Transcript

Dieppe Aquatic Centre – Integration of Sustainable Design



The exterior of the Aquatic Centre is clad with prepainted .76mm (.0299") insulated steel panels, coloured QC2624 Silver Metallic, QC16072 Charcoal and QC16080 Bright Red. Interior liner is prepainted galvanized coloured QC1546 Interior White.

With its colourful steel paneling and floor to ceiling glass walls that allow light to permeate the interior, the Aquatic Centre is an impressive architectural masterpiece that sits in harmony with the natural environment. The landscape features a park-like area and open air retention pond and a continuous passage joins the two parts of the city as it ascends across the building's entry plaza.

Discussing design objectives of the \$9.9 million project, architects at Dan S. Hanganu Architects/Architecture 2000 Inc. en consortium report, "The architectural approach to the Aquatic Centre is generated by its landscape context – the topography, the views and orientation are intrinsic in the design. It is fundamental that the architecture reveal and support the recreational quality of the Aquatic Centre. Our urban and architectural intervention has created a place of interactivity. A social place par excellence for sports, meetings and interaction, the reconstituted public space will enable, by its character and quality, the transformation of the aquatic centre into a true agora."

Construction of the 3,300m² (35,520 sq. ft.) Aquatic Centre began in October 2007 and was substantially completed April 2009. The facility features a principal pool area that can accommodate a maximum of 377 swimmers and also includes a family pool and deck, a two-lane 25 metre warm-up pool and a six-lane 25 metre competition pool, as well as a spectator area. An

extensive glass wall separates the pools from a food court rest area. A linear corridor services a classroom and meeting area, administrative offices, reception and individual change rooms for men, women and families.

Raven Spanier, Dan S. Hanganu Architects /Architecture 2000 Inc. en consortium, comments that the design approach was "founded on a constructional simplicity and based on primary materials and passive natural resources. The envelope is composed of prefabricated insulated steel panels. The quality and finesse of details is provided by the utilization of large openings, glazed entrance canopies and the interplay of colour between these elements."

There were many advantages to using steel for the project. Roland Doucet, Senior Project Manager at Ellis Don, the General Contractors on the project, noted, "The initial install was very impressive. The speed of erection was very fast and the ability to go from a shell to weather tight very quickly is a nice feature of the product."

Raven Spanier agrees. "The prepainted steel panels fit the design nicely by allowing long open spans. Another benefit of steel is its energy efficiency and environmental principles in general coincided with the City of Dieppe's sustainable policies."



The Dieppe Aquatic Centre in New Brunswick is the first part of a three-phase recreational facility being built as part of the new development in the northern part of the city known as Uptown Dieppe. The approach to design is founded on construction simplicity and based on primary materials and passive resources.



"The prepainted steel panels fit the design nicely by allowing long open spans. Another benefit of steel is its energyefficiency and environmental principles in general coincided with the City of Dieppe's sustainable policies."

Raven Spanier, Architecture 2000

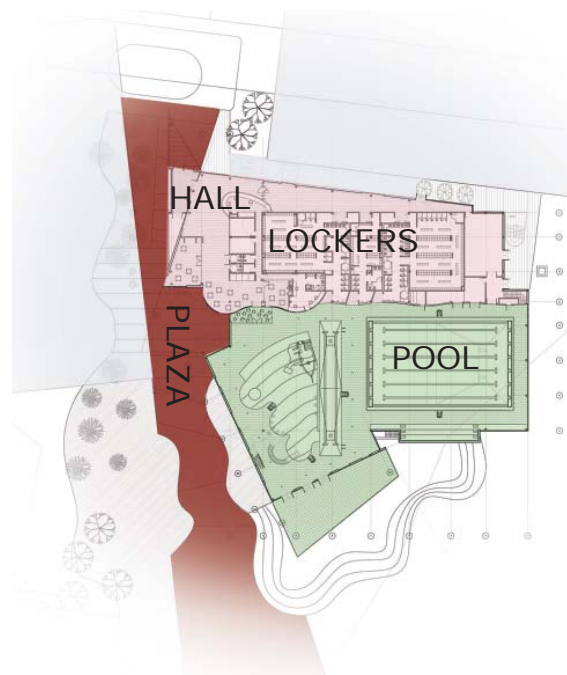

Insulated Steel Wall Panels

Vicwest supplied 76.2mm (3") thick AccuSpeed Insulated Steel Panels with 1,067mm (42") coverage.

The exterior sheets consist of:

- 929m² (10,000 sq. ft). prepainted galvanized to ASTM 653, .76mm (.0299") coloured QC2624 Silver Metallic
- 232m² (2,500 sq. ft). prepainted Galvalume to ASTM 792, .76mm (.0299") coloured QC16072 Charcoal
- 465m² (5,000 sq. ft) prepainted Galvalume coloured QC16080 Bright Red.

The interior liner is:

Prepainted galvanized to ASTM 653, .45mm (.0179") coloured QC1546 Interior White 4/0.



Canadian Sheet Steel Building Institute
 652 Bishop St. N., Unit 2A
 Cambridge, ON N3H 4V6
 Tel: (519) 650-1285
 Fax (519) 650-8081
 www.cssbi.ca